

THUNDER MOUNTAIN RANCH

RECREATIONAL SUBDIVISION
PHASE II

ENGINEERING · PLANNING · SURVEYING

NWE NORTHWESTERN
 ENGINEERING
 INC.

196 PARK AVENUE POCA TELLO, IDAHO
 PHONE (208)233-7341 P.O. BOX 846

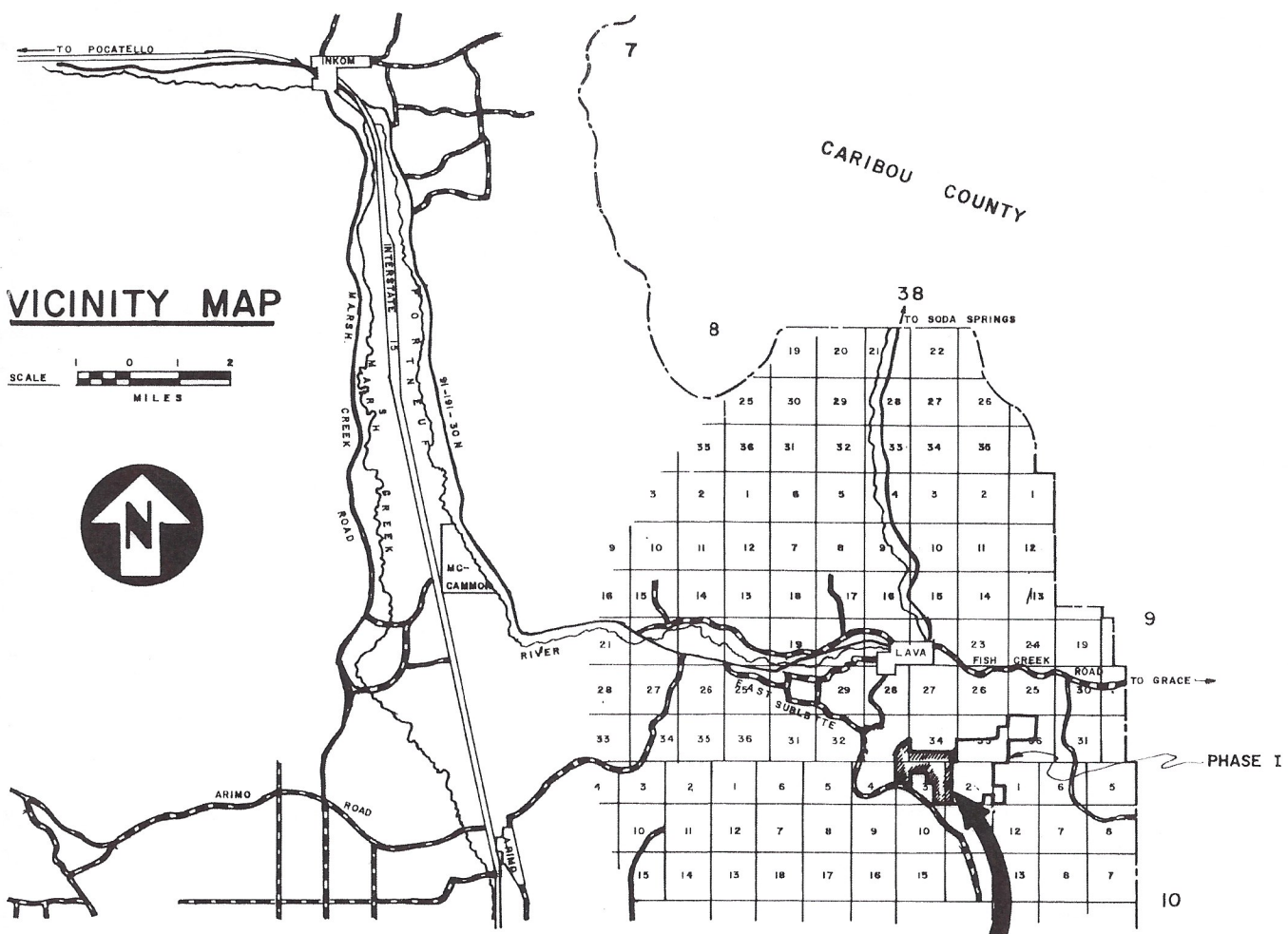

THUNDER MOUNTAIN RANCH PHASE II

SURVEYOR

I, THOMAS W. STOUTENBURG, A LICENSED LAND SURVEYOR OF THE STATE OF IDAHO, DO HEREBY CERTIFY THAT A SURVEY WAS MADE UNDER MY DIRECTION, OF THE PREMISES DESCRIBED IN THE OWNERS CERTIFICATE AND THAT THE PLAT UPON WHICH THIS CERTIFICATE APPEARS WAS MADE UNDER MY DIRECTION; THAT SAID PLAT SHOWS THE WHOLE OF DESCRIBED LAND, THE SAME KNOWN AS THUNDER MOUNTAIN RANCH PHASE II, A SUB-DIVISION IN BANNOCK COUNTY, IDAHO; THAT SAID PLAT CORRECTLY REPRESENTS THE LOTS AND BLOCKS AS THEY ARE MARKED UPON THE GROUND, AND THAT THE PERTINENT PROVISIONS OF THE STATE OF IDAHO HAVE BEEN COMPLIED WITH; I FURTHER CERTIFY THAT THIS IS A TRUE COPY OF SAID PLAT.

Thomas W. Stoutenburg
THOMAS W. STOUTENBURG-LS 968

SUBSCRIBED AND SWORN TO THIS 15 DAY OF June, 1978.

Shirley J. Ardit
NOTARY PUBLIC
STATE OF IDAHO

COUNTY ENGINEER

I, LES BALLIF, DO HEREBY CERTIFY THAT I HAVE REVIEWED THE PLAT OF THUNDER MOUNTAIN RANCH PHASE II, AND FIND THAT THE LEGAL DESCRIPTION ON THE PLAT CONFORMS TO THE DRAWING OF THE PROPERTY TO BE SUBDIVIDED.

Les Ballif
LES BALLIF--BANNOCK COUNTY ENGINEER

COUNTY COMMISSIONERS

I, WAYNE HALL, CHAIRMAN OF THE BOARD OF COMMISSIONERS OF BANNOCK COUNTY, IDAHO, DO HEREBY CERTIFY THAT THE ACCOMPANYING PLAT OF THUNDER MOUNTAIN RANCH PHASE II WAS APPROVED AND ACCEPTED BY SAID BOARD THIS 10 DAY OF August, 1978.

Wayne Hall
CHAIRMAN

Tim Eider
COUNTY CLERK

COUNTY RECORDER

I, TIM ERIKSEN, RECORDER OF BANNOCK COUNTY, IDAHO, DO HEREBY CERTIFY THAT THIS IS A TRUE COPY OF THE PLAT OF THUNDER MOUNTAIN RANCH PHASE II, A SUBDIVISION IN BANNOCK COUNTY, IDAHO.

Tim Eider
RECORDER

INSTRUMENT NO. 606112 TIME 3:51 PM DATE 8-10-78
BOOK 10 PAGE 30

RECORDS OF BANNOCK COUNTY, IDAHO.

RECORDER Tim Eider FEE 10⁰⁰

AT REQUEST OF NORTHWESTERN ENGINEERING, INC.

5/2/83
10/2/83



SCALE: 1"=200'

LEGEND

1. • - 1/2" X 24" IRON PIN (LOT CORNERS)
 ○ - 5/8" X 24" IRON PIN (SUBDIVISION CORNERS)
 △ - FOUND BRASS CAP MONUMENT
 ▲ - SET BRASS CAP MONUMENT
2. ALL EASEMENTS ARE INTENDED FOR COMMON USE UNLESS OTHERWISE SHOWN AND NOTED.
3. 10' UTILITY EASEMENTS TO RUN PARALLEL TO OR CONCENTRIC TO ALL ROAD RIGHT OF WAYS.
4. COMMON USE EASEMENTS ARE TO BE 40' WIDE INSIDE EACH LOT AS SHOWN.
5. ALL ROADWAY RIGHT OF WAY WIDTHS TO BE 50.00 FEET.
6. ALL CUL DE SAC RADII TO BE 45.00 FEET.
7. SANITARY RESTRICTIONS IN FORCE UNDER TITLE 50, CHAPTER 13, IDAHO CODE.

THUNDER MOUNTAIN PHASE I

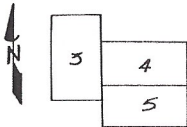

THUNDER MOUNTAIN
PHASE II



**NORTHWESTERN
ENGINEERING
INC.**

ENGINEERING · PLANNING · SURVEYING

196 PARK AVE. POCATELLO, IDAHO
PHONE (208) 233-7341 P.O. BOX 846